

HYDE PARK

— PRESTIGE —

**SERVICED APARTMENTS
& COMMERCIAL OUTLETS**

A PROJECT OF



IRTIQA
Powered By Awan Properties

HYDE PARK

— PRESTIGE —

BASEMENT-2

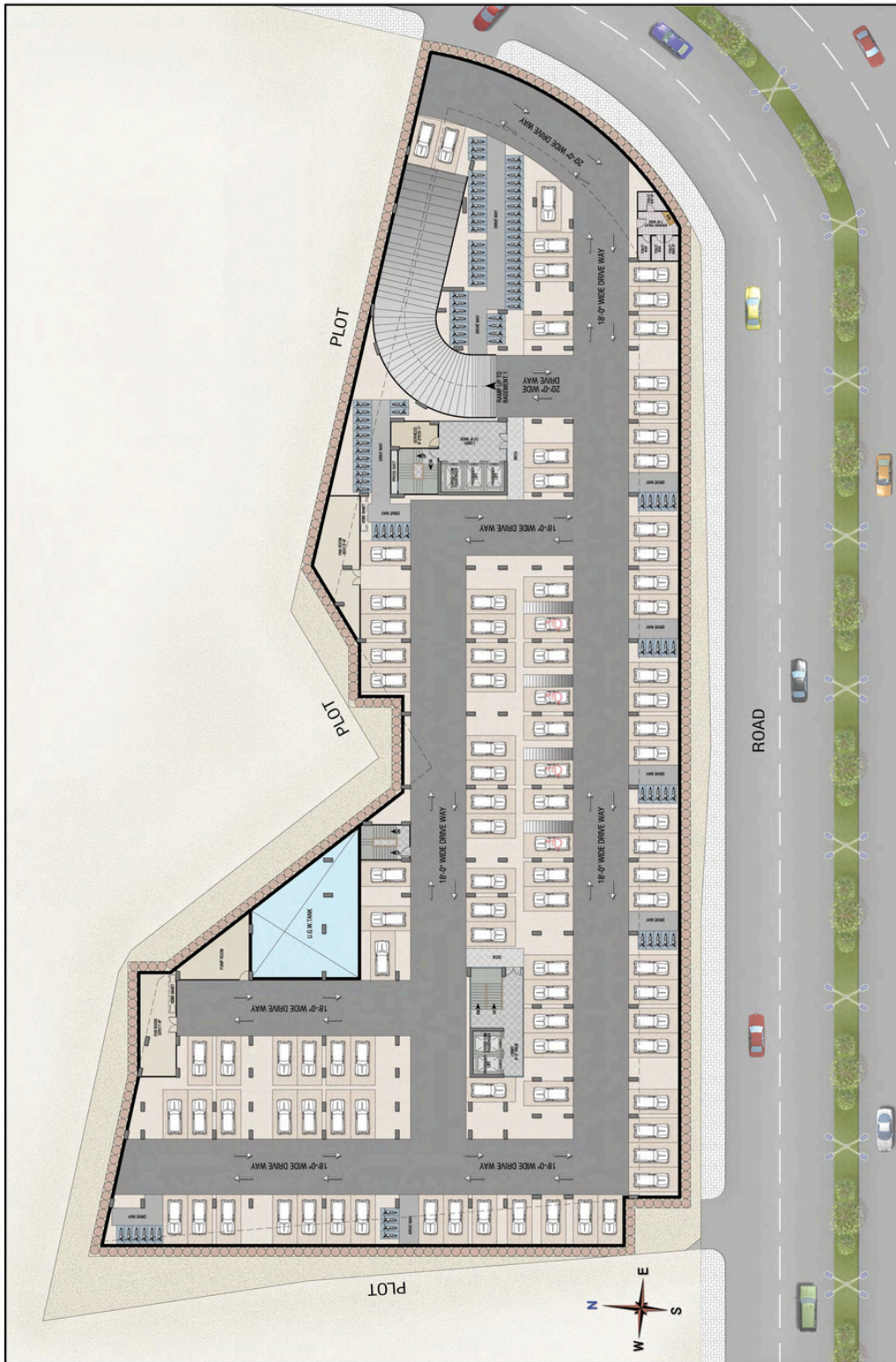

BOOKING OFFICE

Irtiqa House
Potohar Avenue, Gate 4,
Phase II , DHA Islamabad, Pakistan.

IRTIQA
Powered By Awan Properties

HYDE PARK

— PRESTIGE —

BASEMENT-1

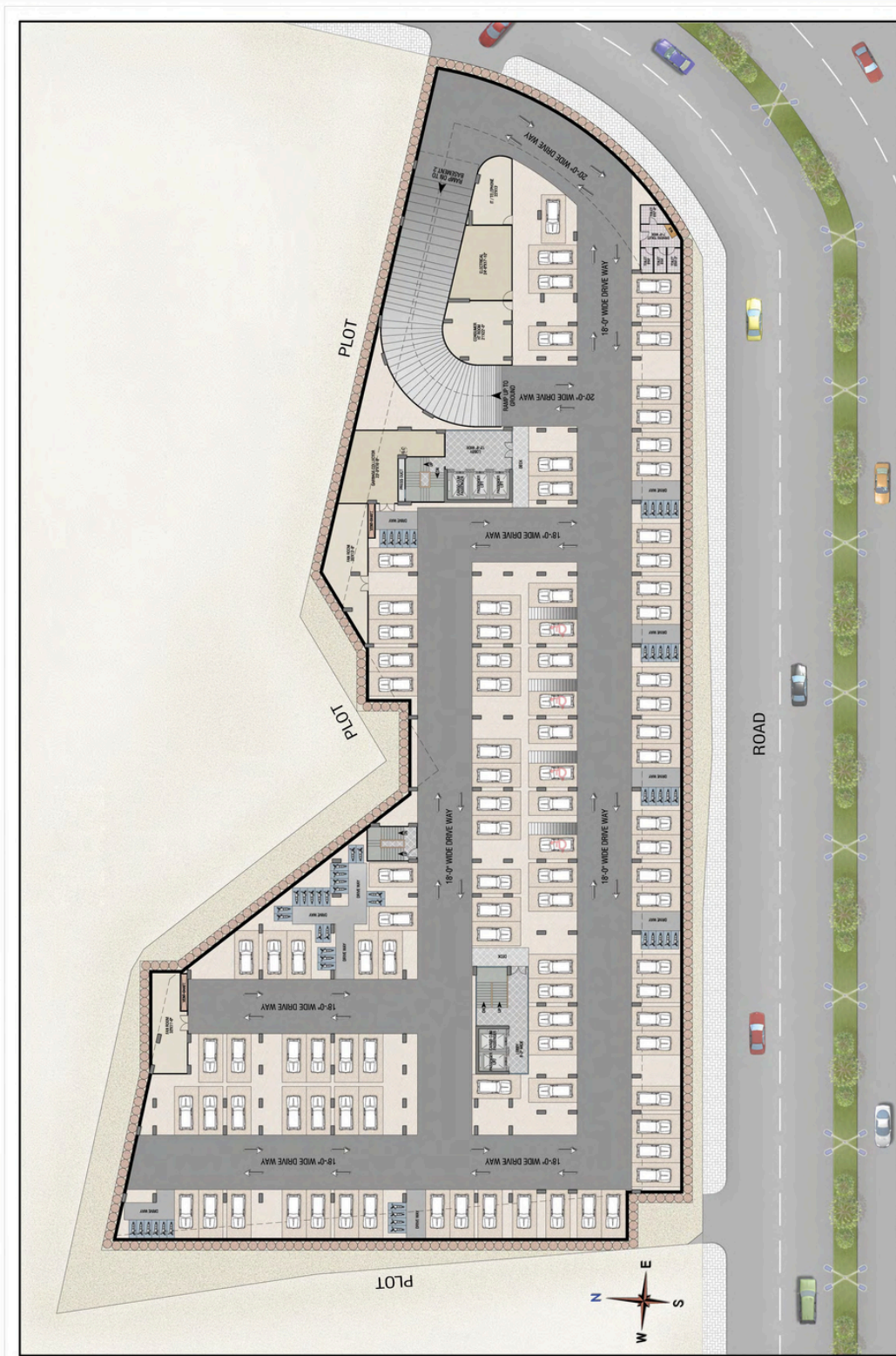

BOOKING OFFICE

Irtiqa House
Potohar Avenue, Gate 4,
Phase II , DHA Islamabad, Pakistan.

IRTIQA
Powered By Awan Properties

HYDE PARK

PRESTIGE

UPPER GROUND FLOOR



BOOKING OFFICE

Irtiqa House
 Potohar Avenue, Gate 4,
 Phase II, DHA Islamabad, Pakistan.

IRTIQA
 Powered By Awan Properties

HYDE PARK

— PRESTIGE —

TYPICAL FLOOR

1ST – 5TH FLOOR



BOOKING OFFICE

Irtiqa House
Potohar Avenue, Gate 4,
Phase II, DHA Islamabad, Pakistan.

IRTIQA
Powered By Awan Properties

HYDE PARK

PRESTIGE

PRESTIGE SUITE



TOTAL AREA = 1250.00 SFT.

BOOKING OFFICE

Irtiqa House
Potohar Avenue, Gate 4,
Phase II, DHA Islamabad, Pakistan.

IRTIQA
Powered By Awan Properties

HYDE PARK

— PRESTIGE —

PRESTIGE SUITE-1



TOTAL AREA = 1150.00 SFT.

BOOKING OFFICE

Irtiqa House
Potohar Avenue, Gate 4,
Phase II, DHA Islamabad, Pakistan.

IRTIQA
Powered By Awan Properties

HYDE PARK

PRESTIGE

PRESTIGE SUITE-2



TOTAL AREA = 1100.00 SFT.

BOOKING OFFICE

Irtiqa House
Potohar Avenue, Gate 4,
Phase II, DHA Islamabad, Pakistan.

IRTIQA
Powered By Awan Properties

HYDE PARK

— PRESTIGE —

SIGNATURE SUITE



TOTAL AREA = 675.00 SFT.

BOOKING OFFICE

Irtiqa House
Potohar Avenue, Gate 4,
Phase II, DHA Islamabad, Pakistan.

IRTIQA
Powered By Awan Properties

IRTIQA

Powered By Awan Properties

BOOKING OFFICE

Irtiqa House
Potohar Avenue, Gate 4,
Phase II , DHA Islamabad, Pakistan.

irtiqagroup.com | [@theirtiqagroup](https://www.instagram.com/theirtiqagroup)
UAN +92 304 1111 702